

KEY DEVELOPMENT PARTNERS

(SWQ) WEBER RD AND BOUGHTON RD
 VILLAGE OF BOLINGBROOK
 WILL COUNTY, ILLINOIS
 ZONING: B-2 COMMUNITY RETAIL

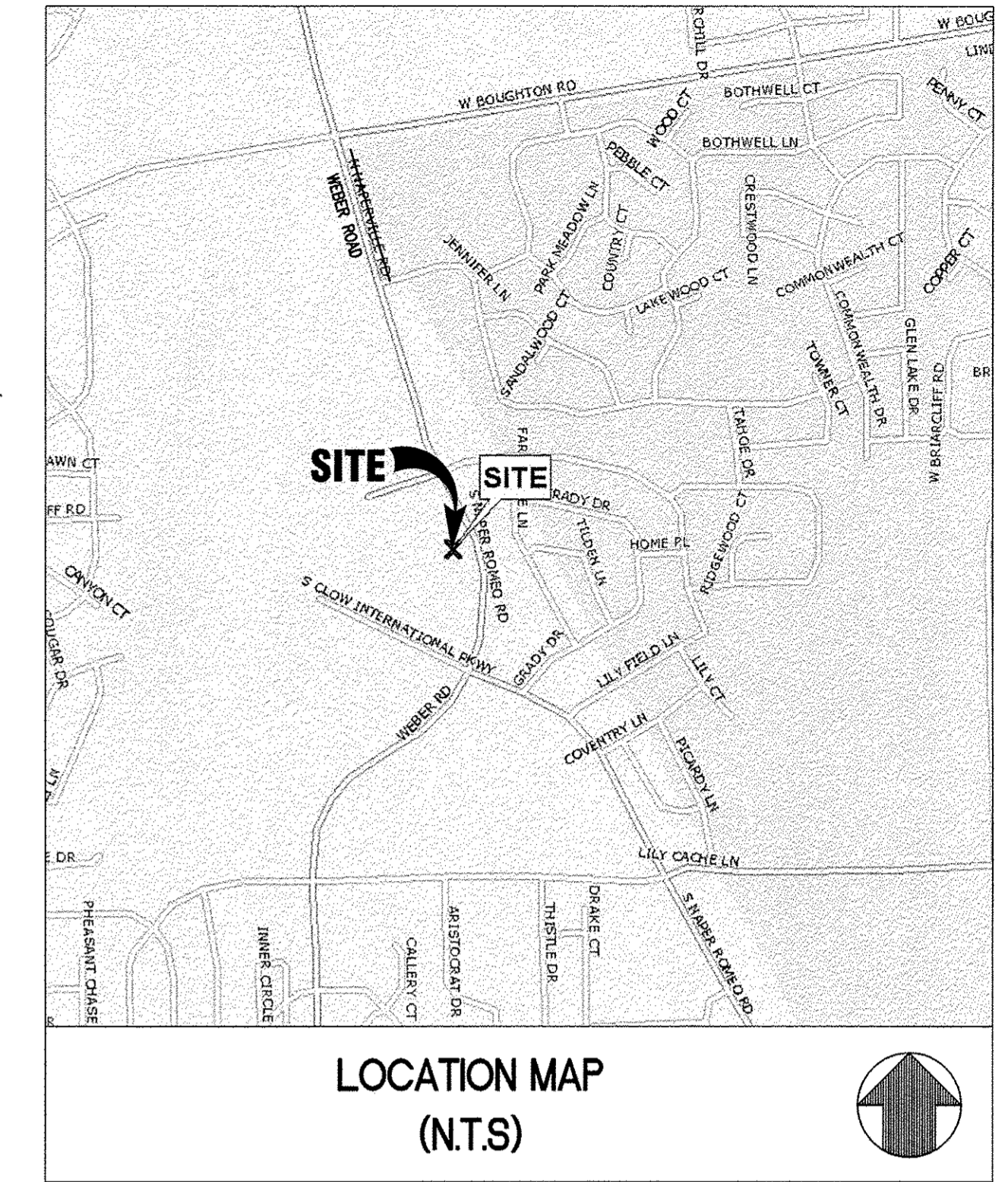

SHEET INDEX:

- C0.0 COVER SHEET
- C1.0 GENERAL NOTES
- C2.0 DEMOLITION PLAN
- C3.0 SITE PLAN
- C4.0 GRADING PLAN
- C5.0 UTILITY PLAN
- C6.0 STORMWATER POLLUTION PREVENTION PLAN
- C7.0 STANDARD DETAILS SHEET 1

ATTACHMENTS

ALTA/ACSM LAND TITLE SURVEY/PLAT - 4 PGS (BY OTHERS)
 BOLINGBROOK STANDARD DETAIL SHEETS - 10 PGS

- L1.0 TREE PRESERVATION PLAN
- L1.1 LANDSCAPE PLAN
- L2.0 LANDSCAPE NOTES AND DETAILS
- L2.1 IRRIGATION NOTES AND DETAILS

SURVEYOR

ALTA/ACSM LAND TITLE SURVEY
 COMPASS SURVEYING LTD
 2631 GINGER WOODS PARKWAY, STE. 100
 AURORA, IL 60502
 T: (630) 820-9100 F: (630) 820-7030
 SURVEYOR'S JOB NO. 11.0170 & 14.0089

GEOTECHNICAL ENGINEER:

APPLIED GEOSCIENCE, INC.
 2385 HAMMOND DRIVE, SUITE 6
 SCHAUMBURG, IL 60173
 TEL: (847) 303-0300
 PROJECT NO. 14-215

DEVELOPER:

KEY DEVELOPMENT PARTNERS

CONTACT: STEVE PANKO
 KEY DEVELOPMENT PARTNERS, LLC.
 515 N. STATE, SUITE 2660
 CHICAGO, IL 60654
 TEL: (312) 379-5101

ENGINEER:

GreenbergFarrow

CONTACT: KERI WILLIAMS, PE
 21 SOUTH EVERGREEN AVENUE, SUITE 200
 ARLINGTON HEIGHTS, IL 60005
 TEL: (847) 788-9200

TENANT MAILING ADDRESS:

1. TENANT 1 - 123 N. WEBER ROAD

HOME DEPOT NOTES:

1. THE CONTRACTOR SHALL CONTACT THE HOME DEPOT PROJECT MANGER, 14 DAYS IN ADVANCE, TO ATTEND THE PRE-CONSTRUCTION MEETING. MEETING SHALL TAKE PLACE ONSITE IN THE CONSTRUCTION TRAILER.
2. WORK OUTSIDE OF THE CARVE OUT PARCEL, BUT ON THE HOME DEPOT PARCEL SHALL FOLLOW "THE HOME DEPOT SITE SPECIFICATION REFERENCES FOR CARVE OUTS".

FLOOD NOTE:

THIS SITE FALLS WITHIN "OTHER AREAS: ZONE "X" (AREAS DETERMINED TO BE OUTSIDE 500-YEAR FLOODPLAIN) AS DEFINED BY THE FLOOD INSURANCE RATE MAP, MAP NUMBERS 17197C0034 E AND 17197C0053 E, BOTH HAVING EFFECTIVE DATES OF SEPTEMBER 6, 1995.

BENCHMARK:

REFERENCE BENCHMARK:
 COUNTY OF WILL CONTROL MONUMENT 6067 (NAVD88)
 TABLE STAMPED "639.15 1982" IN THE SOUTHEAST HEADWALL OF BRIDGE OVER THE EAST BRANCH OF THE DUPAGE RIVER NEAR THE NORTHEAST CORNER OF SECTION 7.
 ELEVATION = 638.20

SITE BENCHMARKS:

SITE BENCHMARK 1
 FINISHED FLOOR AT FRONT SOUTHEAST DOOR OF STEAK-N-SHAKE.
 ELEVATION = 671.03

SITE BENCHMARK 2
 CROSS CUT IN THE SOUTH SIDE OF CONCRETE TRAFFIC SIGNAL BASE.
 ELEVATION = 673.16



CONTACTS:

WATER:

ISRAEL SANDOVAL
 NEW BUSINESS SUPERVISOR
 ILLINOIS AMERICAN WATER COMPANY
 CHICAGO METRO OFFICE
 1000 INTERNATIONALE PARKWAY
 WOODRIDGE, IL 60517
 TEL: (630) 739 8831
 CELL: (630) 816 2619
 FAX: (630) 739 0477
 EMAIL: ISRAEL.SANDOVAL@AMWATER.COM
 WWW.AMWATER.COM

FIRE DEPT.:

JEFFERY R. LAJOIE
 FIRE MARSHAL
 BOLINGBROOK FIRE DEPARTMENT
 375 WEST BRIARCLIFF ROAD
 BOLINGBROOK, IL 60440
 TEL: (630) 226-8551
 FAX: (630) 226-8549
 CELL: (815) 370-5054
 EMAIL: JLJOIE@BOLINGBROOK.COM

GAS

LARRY BLACKBURN
 NEW CONSTRUCTION COORDINATOR -
 CONSTRUCTION OPERATIONS
 NICOR
 3000 EAST CASS STREET
 JOLIET, IL 60432
 TEL: (815) 272-9255
 FAX: (815) 740-6383
 EMAIL: LBLACKB@AGLRESOURCES.COM

SEWER:

THOMAS M. PAWLOWICZ, P.E.
 ASST. TO THE DIRECTOR FOR
 ENGINEERING
 375 WEST BRIARCLIFF ROAD
 BOLINGBROOK, IL 60440
 TEL: (630) 226-8851
 FAX: (630) 226-8809
 EMAIL: TPAWLOWICZ@BOLINGBROOK.COM

DEVELOPER:

STEVE PANKO
 BOLINGBROOK SEMU, LLC.
 515 N. STATE STREET
 SUITE 2660
 CHICAGO, IL 60654
 TEL: (312) 379-5101
 EMAIL: SPANKO@VLANDCORP.COM

ELECTRIC:

PHIL SISTON
 NEW BUSINESS ENGINEER
 COMED
 1040 NORTH JANES AVENUE
 BOLINGBROOK, IL 60440
 TEL: (630) 985-0295
 TEL: (815) 263-3232 CELL
 TEL: (630) 985-4042 FAX
 PHILLIP.SISTON@COMED.COM

PLANNING:

NICOLE M. KNAPP
 PLANNING & ZONING ADMINISTRATOR
 375 WEST BRIARCLIFF ROAD
 BOLINGBROOK, IL 60440
 TEL: (630) 226-8480
 FAX: (630) 226-8469
 EMAIL: NKNAPP@BOLINGBROOK.COM

TELEPHONE:

JIM PERSIN
 DESIGN ENGINEER
 AT&T
 TEL: (815) 727-0566
 TEL: (708) 256-6187
 EMAIL: JPB128@ATT.COM

CABLE TV:

MARTHA GIERAS
 COMCAST CABLE
 TEL: (630) 600-6352
 FAX: (630) 600-6390

ENGINEERING:

THOMAS M. PAWLOWICZ, P.E.
 ASST. TO THE DIRECTOR FOR ENGINEERING
 375 WEST BRIARCLIFF ROAD
 BOLINGBROOK, IL 60440
 TEL: (630) 226-8851
 FAX: (630) 226-8809
 EMAIL: TPAWLOWICZ@BOLINGBROOK.COM

PRELIMINARY PLANS
 (NOT FOR CONSTRUCTION)